



Leicester
City Council

LICENSING (HEARINGS) SUB-COMMITTEE

DATE: TUESDAY, 13 JANUARY 2026

TIME: 10:00 am

PLACE: Meeting Room G.58, Ground Floor, Town Hall, Town Hall Square, Leicester, LE1 9BG

Members of the Sub-Committee

Councillors Pickering, Cassidy and Mohammed

Members of the Sub-Committee are summoned to attend the above meeting to consider the items of business listed overleaf.

for Monitoring Officer

Officer contact:

Julian Yeung, Governance Support Officer, email: committees@leicester.gov.uk

Information for Members of the Public

Attending meetings and access to information

You have the right to attend formal meetings such as full Council, committee meetings, City Mayor & Executive Public Briefing and Scrutiny Commissions and see copies of agendas and minutes. On occasion however, meetings may, for reasons set out in law, need to consider some items in private.

Dates of meetings and copies of public agendas and minutes are available on the Council's website at www.cabinet.leicester.gov.uk, from the Council's Customer Service Centre or by contacting us using the details below.

Making meetings accessible to all

Wheelchair access – Public meeting rooms at the City Hall are accessible to wheelchair users. Wheelchair access to City Hall is from the middle entrance door on Charles Street - press the plate on the right hand side of the door to open the door automatically.

Braille/audio tape/translation - If you require this please contact the Governance Support Officer (production times will depend upon equipment/facility availability).

Induction loops - There are induction loop facilities in City Hall meeting rooms. Please speak to the Governance Support Officer using the details below.

Filming and Recording the Meeting - The Council is committed to transparency and supports efforts to record and share reports of proceedings of public meetings through a variety of means, including social media. In accordance with government regulations and the Council's policy, persons and press attending any meeting of the Council open to the public (except Licensing Sub Committees and where the public have been formally excluded) are allowed to record and/or report all or part of that meeting. Details of the Council's policy are available at www.leicester.gov.uk or from Governance Services.

If you intend to film or make an audio recording of a meeting you are asked to notify the relevant Governance Support Officer in advance of the meeting to ensure that participants can be notified in advance and consideration given to practicalities such as allocating appropriate space in the public gallery etc..

The aim of the Regulations and of the Council's policy is to encourage public interest and engagement so in recording or reporting on proceedings members of the public are asked:

- ✓ to respect the right of others to view and hear debates without interruption;
- ✓ to ensure that the sound on any device is fully muted and intrusive lighting avoided;
- ✓ where filming, to only focus on those people actively participating in the meeting;
- ✓ where filming, to (via the Chair of the meeting) ensure that those present are aware that they may be filmed and respect any requests to not be filmed.

Further information

If you have any queries about any of the above or the business to be discussed, please contact us on committees@leicester.gov.uk, or call in at City Hall.

For Press Enquiries - please phone the **Communications Unit on 0116 454 4151**.

LEICESTER CITY COUNCIL LICENSING SUB-COMMITTEE PROCEDURAL GUIDE

INTRODUCTORY PHASE

The meeting will be held in public unless stated otherwise in the report.

Present at the hearing will be Members of the Licensing Sub-Committee (minimum 3 Members), Officers from the Licensing Authority, a Legal Adviser to the Sub-Committee, an Officer from Governance Services.

1. Participants at the meeting will introduce themselves as follows:
 - a. Members and Officers
 - b. Statutory Consultees (if any)
 - c. The Applicant and any representatives
 - d. Persons who have made representations
2. The Chair will check that the Applicant has received a copy of the Officer report.

INFORMATION GATHERING

(*Please Note – for the purposes of a hearing to determine an application in a Cumulative Impact Zone (CIZ), the Applicant will present their case first)

3. The Licensing Officer presents the report (previously circulated)

Questions (for clarification purposes only):
Members
Statutory Consultees (if any)
Persons who have made representations
Applicant and Representative(s)
4. Depending on the nature of the report, Statutory Consultees present their comments.

Questions (for clarification purposes only):
Members
Officers
Persons who have made representations
Applicant and Representative(s)
5. Persons who have made representations

Questions (for clarification purposes only):
Members
Officers
Statutory Consultees (is any)
Applicant and Representative(s)
6. *Applicant's Case

Questions (for clarification purposes only):
Members
Officers

Statutory Consultees
Persons who have made representations

7. Summing up in the following order

Officers
Statutory Consultees
Persons who have made representations
*Applicant and Representative(s)

8. The Legal Adviser to the Sub-Committee to advise the Sub-Committee in the presence of the Applicant, Representatives, Officers, Statutory Consultees, and persons who have made representations on relevant issues the Members need to be aware of when they come to make their decision.

DECISION MAKING

9. Apart from the Sub-Committee Members and the Governance Support Officer everyone will be asked to withdraw from the meeting The Legal Adviser to the Sub-Committee may be called back to the meeting to advise on the wording of the decision the Sub-Committee Members will have made during private deliberation.
10. The Applicant will be advised that the decision made by the Sub-Committee will be made public within 5 working days of the meeting.

PUBLIC SESSION

AGENDA

FIRE / EMERGENCY EVACUATION

If the emergency alarm sounds, you must evacuate the building immediately by the nearest available fire exit and proceed to the area outside the Ramada Encore Hotel on Charles Street as directed by Governance Services staff. Further instructions will then be given.

1. Appointment of Chair

2. Apologies for Absence

3. Declarations of Interest

Members are asked to declare any interests they may have in the business to be discussed.

4. Minutes of Previous Meeting

[Appendix A](#)

(Pages 1 - 4)

The minutes of the previous meeting held on 17th November 2025 are attached and members will be asked to confirm them as a correct record.

5. Private Session

AGENDA

MEMBERS OF THE PUBLIC TO NOTE

Under the law, the Sub-Committee is entitled to consider certain items in private where in the circumstances the public interest in maintaining the matter exempt from publication outweighs the public interest in disclosing the information.

Members of the public will be asked to leave the meeting when such items are discussed.

The Sub-Committee is recommended to consider the following reports in private on the grounds that they contain 'exempt' information as defined by the Local Government (Access to Information) Act 1985, as amended, and consequently that the Sub-Committee makes the following resolution:- "that the press and public be excluded during consideration of the following reports in accordance with the provisions of Section 100A(4) of the Local Government Act 1972, as amended, because they involve the likely disclosure of 'exempt' information, as defined in the Paragraphs detailed below of Part 1 of Schedule 12A of the Act, and taking all the circumstances into account, it is considered that the public interest in maintaining the information as exempt outweighs the public interest in disclosing the information."

Paragraph 1

Information relating to an individual.

Paragraph 2

Information which is likely to reveal the identity of an individual.

Paragraph 7

Information relating to any action taken or to be taken in connection with the prevention, investigation or prosecution of crime.

B1) APPLICATION FOR A REVIEW OF AN EXISTING PREMISES LICENCE - LIFESTYLE EXPRESS, 29 HALFORD STREET, LEICESTER

6. **Application for a Review of an Existing Premises Licence - Lifestyle Express, 29 Halford Street, Leicester** [Appendix B](#)
(Pages 5 - 32)

The Director of Neighbourhood and Environmental Services submits a report for an application for a review of an existing premises licence for Lifestyle Express, 29 Halford Street, Leicester.

7. **Public Session**

8. **Application for a New Premises Licence - Amigo Grill, 27 Narborough Road, Leicester** [Appendix C](#)
(Pages 33 - 68)

The Director of Neighbourhood and Environmental Services submits a report for an application for a new premises licence for Amigo Grill, 27 Narborough Road, Leicester.

9. Any Other Urgent Business



Leicester
City Council

Minutes of the Meeting of the
LICENSING (HEARINGS) SUB-COMMITTEE

Held: MONDAY, 17 NOVEMBER 2025 at 10:00 am

P R E S E N T:

Councillor Pickering (Chair)

Councillor Cank

Councillor Chauhan

* * * * *

1. APPOINTMENT OF CHAIR

Councillor Pickering was appointed as Chair.

2. APOLOGIES FOR ABSENCE

There were no apologies for absence.

3. DECLARATIONS OF INTEREST

There were no declarations of interest.

4. MINUTES OF PREVIOUS MEETING

The minutes of the previous meetings held 2 July 2025 and 8 September 2025 were recorded as a true and accurate record.

5. PRIVATE SESSION

RESOLVED:

That the press and public be excluded during consideration of the following reports in accordance with the provisions of Section 100A(4) of the Local Government Act 1972, as amended, because it involves the likely disclosure of 'exempt' information, as defined in the Paragraphs detailed below of Part 1 of Schedule 12A of the Act, and taking all the circumstances into account, it is considered that the public interest in maintaining the information as exempt outweighs the public interest in disclosing the information.

Paragraph 1

Information relating to an individual.

Paragraph 2

Information which is likely to reveal the identity of an individual.

Paragraph 7

Information relating to any action taken or to be taken in connection with the prevention, investigation or prosecution of crime.

B1) Application for a Review of an Existing Premises Licence - Baltic, 128a Narborough Road, Leicester, LE3 0BT

6. APPLICATION FOR A REVIEW OF AN EXISTING PREMISES LICENCE - BALTIC, 128A NARBOROUGH ROAD, LEICESTER, LE3 0BT

Prior to the start of the hearing, an email reportedly from Mr Nazar Obaid, the Premises Licence Holder, was received by the Sub-Committee at 10:23am on 17th November to confirm that he instructed Mr Rob Edge, licensing agent from Licence Leader Ltd, as his representative at the hearing.

Councillor Pickering, as Chair led on introductions and outlined the procedure the hearing would follow.

The Director of Neighbourhood and Environmental Services submitted a report on an application for a review of an existing premises licence for Baltic, 128a Narborough Road, Leicester, LE3 0BT.

PC Jeff Pritchard and PC Robert Gist were present having made representations on behalf of Leicestershire Police. Noel Cazley, Fatema Burani and Robert Lowe from Trading Standards were in attendance as witnesses. Mr Rob Edge, licensing agent was present to represent the Licence Holder. Also present were the Service Manager (Regulatory Services) and the Legal Adviser to the Sub-Committee.

Following the commencement of the hearing, Mr Edge informed the Sub-Committee that in light of information he had come across prior to the hearing, he was instructed to offer to surrender the licence with immediate effect.

PC Pritchard representing the Police asked for a short adjournment to consider the offer of a surrender of a licence.

Following a short adjournment, PC Pritchard requested the committee to determine the application for a review as the offer of a surrender did not preclude an application for a transfer of the premises licence.

Section 28 of the Licensing Act 2003 requires the Premises Licence Holder to give notice to the Licensing Authority. The Notice must be accompanied by the premises licence. The Premises Licence lapses when it is received by the Licensing Authority together with the Notice of Surrender. Section 50 of the Licensing Act 2003 makes provision for reinstatement of a licence surrendered under section 28.

Mr Edge did not object to the request by the Police for committee to proceed and determine the application for review.

Mr Edge did not want to inconvenience the committee beyond what was necessary and confirmed that he was content for the information and evidence for the review to be presented in summary form.

The Service Manager (Regulatory Services) presented the report.

PC Jeff Pritchard was given the opportunity to outline the details of the Police representation.

Mr Edge did not challenge the evidence presented at the hearing or any of the information contained in the review application and supporting evidence.

All parties were given the opportunity to sum up their positions and make any final comments.

The Sub-Committee received legal advice from the Legal Adviser to the Sub-Committee in the presence of all those present and were advised of the options available to them in making their decision.

The Sub-Committee were also advised of the relevant policy and statutory guidance that needed to be taken into account when making their decision,

In reaching their decision, the Sub-Committee felt they should deliberate in private on the basis that this was in the public interest and as such outweighed the public interest of their deliberation taking place with the parties represented present, in accordance with the Licensing Act 2003 (Hearings) Regulations 2005.

The Chair announced that the decisions and reasons would be publicly announced and confirmed in writing within five working days. The Chair informed the meeting that the Legal Adviser to the Sub-Committee would be called back to give advice on the wording of the decision.

The Chair then asked all but Members of the Sub-Committee and Democratic Support Officers to withdraw from the meeting. Members then deliberated in private to consider their decision.

The Sub-Committee recalled the Legal Adviser to the Sub-Committee to give advice on the wording of the decision.

RESOLVED:

That as a result of the representations made to the Sub-Committee, it was satisfied that the representations by Leicestershire Police engaged the licensing objectives relating to the crime and disorder and public safety and committee accordingly determined that in light of the evidence presented to it, it was appropriate and proportionate to **REVOKE** the licence.

The reasons for the decision would be provided in writing to all parties within five working days.

The Premises Licence Holder would be informed of their right to appeal the decision within 21 days of receiving the decision.

7. ANY OTHER URGENT BUSINESS

With there being no further business, the meeting closed at 11:16am.

By virtue of paragraph(s) 1, 2, 7 of Part 1 of Schedule 12A
of the Local Government Act 1972.

Document is Restricted

By virtue of paragraph(s) 1, 2, 7 of Part 1 of Schedule 12A
of the Local Government Act 1972.

Document is Restricted

By virtue of paragraph(s) 1, 2, 7 of Part 1 of Schedule 12A
of the Local Government Act 1972.

Document is Restricted

By virtue of paragraph(s) 1, 2, 7 of Part 1 of Schedule 12A
of the Local Government Act 1972.

Document is Restricted

Application for a new premises licence

Licensing (Hearings) Sub-Committee

Decision to be taken by: Licensing (Hearings)
Sub-Committee

Decision to be taken on/Date of meeting: 13 January
2026

Lead director/officer: Bobby Smiljanic

Useful information

- Ward(s) affected: Westcotes
- Report author: Amy Day
- Author contact details: 0116 454 3054
- Report version number: 1

1. Summary

- 1.1 This report outlines an application under the Licensing Act 2003 for a new premises licence for Amigo Grill, 27 Narborough Road, Leicester and summarises the representations received. It also highlights the licensing objectives and the relevant parts of both the statutory guidance and the Licensing Authority's Licensing Policy.

2. Determination to be made

- 2.1 Having considered the application and representations, Members must consider whether to
- Grant the licence without modification
 - Grant the licence subject to conditions
 - Exclude from the licence any of the licensable activities
 - Refuse to accept the proposed premises supervisor
 - Reject the application

3. Application and promotion of the licensing objectives

- 3.1 An application was received on 13 November 2025 from Haleema Khan for a new premises licence for Amigo Grill, 27 Narborough Road, Leicester. A copy of the application is attached at Appendix A.

- 3.2 The application is as follows:

Licensable activity	Proposed hours
Late night refreshment	Mon – Sun 23.00 – 05.00
Opening hours	Mon – Sun 09.30 – 05.00

- 3.3 The steps the applicant proposes to take to promote the licensing objectives are set out in the operating schedule (see section M of Appendix A).
- 3.4 In arriving at its decision on the application, the Licensing Authority's primary consideration must be the promotion of the licensing objectives.

3.5 Location Plan



4. Representations

- 4.1 A representation was received on 17 November 2025 from the Police. The representation relates to the prevention of crime and disorder, the prevention of public nuisance and the protection of children from harm. The representee is concerned that the premises is located within an area of special interest as referred to in the Council's Statement of Licensing Policy. The applicant has not referred to this policy and the application is very vague and lacks any mitigating measures to promote the licensing objectives. A copy of the representation is attached at Appendix B1.
- 4.2 A representation was received on 09 December 2025 from the Noise team. The representation relates to the prevention of public nuisance. The representee is concerned that the late hours requested would increase noise from the ventilation at the premises, delivery vehicles and people noise which may impact the nearby residents. They have been in contact with the applicant and have agreed conditions. A copy of the representation and agreement is attached at Appendix B2.

5. Conditions

- 5.1 The conditions that are consistent with the application and the representation are attached at Appendix C.

6. Statutory guidance and statement of licensing policy

- 6.1 Any decision made by the Licensing Authority must be in accordance with the licensing objectives. In addition, the government has issued guidance under section 182 of the Licensing Act 2003. The parts of the guidance that are particularly relevant in this case are as follows:

Section	Heading
1.2 – 1.5	Licensing objectives and aims
1.15 – 1.16	General Principles
1.17	Each application on its own merits
2.1 – 2.6	Crime & Disorder
2.15 – 2.21	Public nuisance
2.22 – 2.31	Protection of children from harm
3.12 – 3.20	Late night refreshment
8.41 – 8.49	Steps to promote the licensing objectives
9.11 – 9.12	Role of responsible authorities
9.31 – 9.41	Hearings
9.42 – 9.44	Determining actions that are appropriate for the promotion of the licensing objectives
10.1 – 10.3	Conditions - general
10.8 – 10.9	Imposed conditions
10.10	Proportionality
10.13 - 10.15	Hours of trading
13.10 – 13.11	Giving reasons for decisions
14.51 – 14.52	Licensing Hours

- 6.2 The relevant parts of the Licensing Authority's Statement of Licensing Policy are as follows:

Section	Heading
4	Promotion of the licensing objectives
5	General Principles
6	Premises Licences and Club Premises Certificates
8	Areas of Specific Interest and Consultation

7. Points for clarification

- 7.1 The applicant and the party / parties making the representation have been asked to clarify certain points at the hearing, as follows:

By the applicant

1. Whether the applicant considers that the concerns outlined in the representations are valid, and if not why not.

2. In the light of the representations made, whether the applicant wishes to propose any additional steps for the promotion of the licensing objectives.

By the party making the representation

1. Whether they have any additional information to support the representation they have made.
2. Whether there are any additional steps that could be taken which would be equally effective in the promotion of the licensing objectives.

8. Financial, legal, equalities, climate emergency and other implications

8.1 Financial implications

There are no significant financial implications arising from the contents of this report.

Jade Draper Principal Accountant
22nd December 2025

8.2 Legal implications

Legal advice specific to the application will be provided at the meeting by Legal Officers.

8.3 Equalities implications

Under the Equality Act 2010, public authorities have a Public Sector Equality Duty (PSED) which means that, in carrying out their functions, they have a statutory duty to pay due regard to the need to eliminate unlawful discrimination, harassment and victimisation and other conduct prohibited by the Act, to advance equality of opportunity between people who share a protected characteristic and those who don't and to foster good relations between people who share a protected characteristic and those who don't.

Protected Characteristics under the Equality Act 2010 are age, disability, gender reassignment, marriage and civil partnership, pregnancy and maternity, race, religion or belief, sex, sexual orientation.

There are no direct equalities implications arising from the report. However it is important to consider issues of accessibility to the application process and its associated activities (such as lodging an appeal); The criteria used during determination of an application and its associated activities (such as lodging an appeal).

Surinder Singh, Equalities Officer
Dated: 22nd December 2025

8.4 Climate Emergency implications

There are unlikely to be any significant climate emergency implications directly associated with this report and the licensing process.

Duncan Bell, Change Manager

8.5 Other implications

None.

9. Background information and other papers:

None

10. Summary of appendices:

Appendix A – Application

Appendix B – Representations

Appendix C – Conditions consistent with the application and representation

11. Is this a private report (If so, please indicate the reasons and state why it is not in the public interest to be dealt with publicly)?

No

12. Is this a “key decision”? If so, why?

No

Application for a premises licence to be granted under the Licensing Act 2003

Please read the following instructions first

Before completing this form please read the guidance notes at the end of the form. If you are completing this form by hand please write legibly in block capitals. In all cases ensure that your answers are inside the boxes and written in black ink. Use additional sheets if necessary.

You may wish to keep a copy of the completed form for your records.

I/We HALEEMA KHATOON KHAN
(Insert name(s) of applicant)

apply for a premises licence under section 17 of the Licensing Act 2003 for the premises described in Part 1 below (the premises) and I/we are making this application to you as the relevant licensing authority in accordance with section 12 of the Licensing Act 2003

Part 1 – Premises details

Postal address of premises or, if none, ordnance survey map reference or description <u>AMIGO GRILL</u> <u>27 NARBOROUGH ROAD</u> <u>LEICESTER</u>	
Post town	<u>LEICESTER</u>
Postcode	<u>LE3 0LE</u>

Telephone number at premises (if any)	<u>0116 2913556</u>
Non-domestic rateable value of premises	£ <u>0.00</u>

Part 2 - Applicant details

Please state whether you are applying for a premises licence as appropriate Please tick as appropriate

a)	an individual or individuals *	<input checked="" type="checkbox"/>	A	please complete section (A)
b)	a person other than an individual *	<input type="checkbox"/>		
	i as a limited company/limited liability partnership	<input type="checkbox"/>		please complete section (B)
	ii as a partnership (other than limited liability)	<input type="checkbox"/>		please complete section (B)
	iii as an unincorporated association or	<input type="checkbox"/>		please complete section (B)
	iv other (for example a statutory corporation)	<input type="checkbox"/>		please complete section (B)

c)	a recognised club		please complete section (B)
d)	a charity		please complete section (B)
e)	the proprietor of an educational establishment		please complete section (B)
f)	a health service body		please complete section (B)
g)	a person who is registered under Part 2 of the Care Standards Act 2000 (c14) in respect of an independent hospital in Wales		please complete section (B)
ga)	a person who is registered under Chapter 2 of Part 1 of the Health and Social Care Act 2008 (within the meaning of that Part) in an independent hospital in England		please complete section (B)
h)	the chief officer of police of a police force in England and Wales		please complete section (B)

* If you are applying as a person described in (a) or (b) please confirm (by ticking yes to one box below):

- I am carrying on or proposing to carry on a business which involves the use of the premises for licensable activities; or
- I am making the application pursuant to a
- statutory function or
- a function discharged by virtue of Her Majesty's prerogative

(A) Individual applicants (fill in as applicable)

Mr	Mrs	Miss	<input checked="" type="radio"/> Ms	Other Title (for example, Rev)	
Surname KHAN			First names HALGEMA		
Date of birth		I am 18 years old or over		Please tick yes YES	
Nationality					
Current residential address if different from premises address					
Post town		Postcode			
Daytime contact telephone number					
E-mail address (optional)					
Where applicable (if demonstrating a right to work via the Home Office online right to work checking service), the 'share code' provided to the applicant by that service (please see note 15 for information)					

--

Second individual applicant (if applicable)

Mr	Mrs	Miss	Ms	Other Title (for example, Rev)	
Surname			First names		
Date of birth or over		I am 18 years old		Please tick yes	
Nationality					
Current residential address if different from premises address					
Post town				Postcode	
Daytime contact telephone number					
E-mail address (optional)					
Where applicable (if demonstrating a right to work via the Home Office online right to work checking service), the 'share code' provided to the applicant by that service: (please see note 15 for information)					

(B) Other applicants

Please provide name and registered address of applicant in full. Where appropriate please give any registered number. In the case of a partnership or other joint venture (other than a body corporate), please give the name and address of each party concerned.

Name
Address
Registered number (where applicable)

Description of applicant (for example, partnership, company, unincorporated association etc.)
Telephone number (if any)
E-mail address (optional)

Part 3 Operating Schedule

When do you want the premises licence to start?

DD	MM	YYYY
01	03	2025

If you wish the licence to be valid only for a limited period, when do you want it to end?

DD	MM	YYYY

Please give a general description of the premises (please read guidance note 1)

Hot and Cold desert shop and take away. PIZZA and hot food.
www.redvelvetdessert.com

If 5,000 or more people are expected to attend the premises at any one time, please state the number expected to attend.

--

What licensable activities do you intend to carry on from the premises?

(please see sections 1 and 14 and Schedules 1 and 2 to the Licensing Act 2003)

Provision of regulated entertainment (please read guidance note 2)		Please tick all that apply
a)	plays (if ticking yes, fill in box A)	
b)	films (if ticking yes, fill in box B)	
c)	indoor sporting events (if ticking yes, fill in box C)	
d)	boxing or wrestling entertainment (if ticking yes, fill in box D)	
e)	live music (if ticking yes, fill in box E)	
f)	recorded music (if ticking yes, fill in box F)	

g)	performances of dance (if ticking yes, fill in box G)	
h)	anything of a similar description to that falling within (e), (f) or (g) (if ticking yes, fill in box H)	

Provision of late night refreshment (if ticking yes, fill in box I)	<input checked="" type="checkbox"/>
Supply of alcohol (if ticking yes, fill in box J)	

In all cases complete boxes K, L and M

A

N/A

Plays Standard days and timings (please read guidance note 7)			Will the performance of a play take place indoors or outdoors or both – please tick (please read guidance note 3)	Indoors	
				Outdoors	
Day	Start	Finish		Both	
Mon				Please give further details here (please read guidance note 4)	
Tue					
Wed			State any seasonal variations for performing plays (please read guidance note 5)		
Thur					
Fri			Non standard timings. Where you intend to use the premises for the performance of plays at different times to those listed in the column on the left, please list (please read guidance note 6)		
Sat					
Sun					

B

N/A

Films Standard days and timings (please read guidance note 7)			<u>Will the exhibition of films take place indoors or outdoors or both – please tick</u> (please read guidance note 3)	Indoors	
				Outdoors	
				Both	
Day	Start	Finish	<u>Please give further details here</u> (please read guidance note 4)		
Mon					
Tue					
Wed			<u>State any seasonal variations for the exhibition of films</u> (please read guidance note 5)		
Thur					
Fri					
Sat			<u>Non standard timings. Where you intend to use the premises for the exhibition of films at different times to those listed in the column on the left, please list</u> (please read guidance note 6)		
Sun					

C

N/A

Indoor sporting events Standard days and timings (please read guidance note 7)			<u>Please give further details</u> (please read guidance note 4)
Day	Start	Finish	
Mon			
Tue			<u>State any seasonal variations for indoor sporting events</u> (please read guidance note 5)
Wed			
Thur			<u>Non standard timings. Where you intend to use the premises for indoor sporting events at different times to those listed in the column on the left, please list</u> (please read guidance note 6)
Fri			
Sat			
Sun			

D

N/A

Boxing or wrestling entertainments Standard days and timings (please read guidance note 7)			<u>Will the boxing or wrestling entertainment take place indoors or outdoors or both – please tick</u> (please read guidance note 3)	Indoors	
				Outdoors	
				Both	
Day	Start	Finish	<u>Please give further details here</u> (please read guidance note 4)		
Mon					
Tue					
Wed			<u>State any seasonal variations for boxing or wrestling entertainment</u> (please read guidance note 5)		
Thur					
Fri					
Sat			<u>Non standard timings. Where you intend to use the premises for boxing or wrestling entertainment at different times to those listed in the column on the left, please list</u> (please read guidance note 6)		
Sun					

E

N/A

Live music Standard days and timings (please read guidance note 7)			<u>Will the performance of live music take place indoors or outdoors or both – please tick</u> (please read guidance note 3)	Indoors	
				Outdoors	
				Both	
Day	Start	Finish	<u>Please give further details here</u> (please read guidance note 4)		
Mon					
Tue					
Wed					
Thur			<u>State any seasonal variations for the performance of live music</u> (please read guidance note 5)		
Fri					
Sat			<u>Non standard timings. Where you intend to use the premises for the performance of live music at different times to those listed in the column on the left, please list</u> (please read guidance note 6)		
Sun					

F

N/A

Recorded music Standard days and timings (please read guidance note 7)			Will the playing of recorded music take place indoors or outdoors or both – please tick (please read guidance note 3)	Indoors	
				Outdoors	
				Both	
Day	Start	Finish	Please give further details here (please read guidance note 4)		
Mon					
Tue					
Wed					
Thur			State any seasonal variations for the playing of recorded music (please read guidance note 5)		
Fri					
Sat					
Sun					
			Non standard timings. Where you intend to use the premises for the playing of recorded music at different times to those listed in the column on the left, please list (please read guidance note 6)		

G

N/A.

Performances of dance Standard days and timings (please read guidance note 7)			Will the performance of dance take place indoors or outdoors or both – please tick (please read guidance note 3)	Indoors	
				Outdoors	
Day	Start	Finish		Both	
Mon				Please give further details here (please read guidance note 4)	
Tue					
Wed			State any seasonal variations for the performance of dance (please read guidance note 5)		
Thur					
Fri			Non standard timings. Where you intend to use the premises for the performance of dance at different times to those listed in the column on the left, please list (please read guidance note 6)		
Sat					
Sun					

H

N/A

Anything of a similar description to that falling within (e), (f) or (g) Standard days and timings (please read guidance note 7)			Please give a description of the type of entertainment you will be providing		
Day	Start	Finis h	<u>Will this entertainment take place indoors or outdoors or both – please tick</u> (please read guidance note 3)	Indoors	
Mon				Outdoors	
				Both	
Tue			<u>Please give further details here</u> (please read guidance note 4)		
Wed					
Thur			<u>State any seasonal variations for entertainment of a similar description to that falling within (e), (f) or (g)</u> (please read guidance note 5)		
Fri					
Sat			<u>Non standard timings. Where you intend to use the premises for the entertainment of a similar description to that falling within (e), (f) or (g) at different times to those listed in the column on the left, please list</u> (please read guidance note 6)		
Sun					

Late night refreshment Standard days and timings (please read guidance note 7)			Will the provision of late night refreshment take place indoors or outdoors or both – please tick (please read guidance note 3) Indoors <input checked="" type="checkbox"/>	
			Outdoors <input type="checkbox"/>	
			Both <input type="checkbox"/>	
Day	Start	Finish	Inside the Shop <u>Please give further details here</u> (please read guidance note 4) Very soft pre-recorded music may be played in the back-ground via a non amplified CD player <u>State any seasonal variations for the provision of late night refreshment</u> (please read guidance note 5) Due to the nature of the business and the current market <u>Non standard timings. Where you intend to use the premises for the provision of late night refreshment at different times, to those listed in the column on the left, please list</u> (please read guidance note 6) MON-SUN 7 DAYS PER WEEK 23:00 - 05:00	
Mon	23:00	05:00		
Tue	23:00	05:00		
Wed	23:00	05:00		
Thur	23:00	05:00		
Fri	23:00	05:00		
Sat	23:00	05:00		
Sun	23:00	05:00		

J

N/A

Supply of alcohol Standard days and timings (please read guidance note 7)			Will the supply of alcohol be for consumption – please tick (please read guidance note 8)	On the premises	
				Off the premises	
				Both	
Day	Start	Finish	State any seasonal variations for the supply of alcohol (please read guidance note 5)		
Mon					
Tue					
Wed					
Thur					
Fri					
Sat					
Sun			Non standard timings. Where you intend to use the premises for the supply of alcohol at different times to those listed in the column on the left, please list (please read guidance note 6)		

State the name and details of the individual whom you wish to specify on the licence as designated premises supervisor (Please see declaration about the entitlement to work in the checklist at the end of the form):

Name	
Date of birth	
Address	
Postcode	
Personal licence number (if known)	
Issuing licensing authority (if known)	

M

Describe the steps you intend to take to promote the four licensing objectives:

a) General – all four licensing objectives (b, c, d and e) (please read guidance note 10)

We are not serving any alcohol products

b) The prevention of crime and disorder

CCTV and trained staff members

c) Public safety

CCTV IS in place and we are a family outfit.

d) The prevention of public nuisance

Well trained staff and training is provided on a regular basis

e) The protection of children from harm

N/A .

Checklist:

Please tick to indicate agreement

<input checked="" type="checkbox"/>	I have made or enclosed payment of the fee.	<input checked="" type="checkbox"/>
<input checked="" type="checkbox"/>	I have enclosed the plan of the premises.	<input checked="" type="checkbox"/>
<input checked="" type="checkbox"/>	I have sent copies of this application and the plan to responsible authorities and others where applicable.	<input checked="" type="checkbox"/>
<input type="checkbox"/>	I have enclosed the consent form completed by the individual I wish to be designated premises supervisor, if applicable.	<input type="checkbox"/>
<input checked="" type="checkbox"/>	I understand that I must now advertise my application.	<input checked="" type="checkbox"/>
<input checked="" type="checkbox"/>	I understand that if I do not comply with the above requirements my application will be rejected.	<input type="checkbox"/>
<input checked="" type="checkbox"/>	[Applicable to all individual applicants, including those in a partnership which is not a limited liability partnership, but not companies or limited liability partnerships] I have included documents demonstrating my entitlement to work in the United Kingdom or my share code issued by the Home Office online right to work checking service (please read note 15).	<input checked="" type="checkbox"/>

It is an offence, under Section 158 of the Licensing Act 2003, to make a false statement in or in connection with this application. Those who make a false statement may be liable on summary conviction to a fine of any amount.

It is an offence under Section 24b of the Immigration Act 1971 for a person to work when they know, or have reasonable cause to believe, that they are disqualified from doing so by reason of their immigration status. Those who employ an adult without leave or who is subject to conditions as to employment will be liable to a civil penalty under section 15 of the Immigration, Asylum and Nationality Act 2006 and pursuant to Section 21 of the same act, will be committing an offence where they do so in the knowledge, or with reasonable cause to believe, that the employee is disqualified.

Part 4 – Signatures (please read guidance note 11)

Signature of applicant or applicant's solicitor or other duly authorised agent (see guidance note 12). If signing on behalf of the applicant, please state in what capacity.

Declaration	<ul style="list-style-type: none"> [Applicable to individual applicants only, including those in a partnership which is not a limited liability partnership] I understand I am not entitled to be issued with a licence if I do not have the entitlement to live and work in the UK (or if I am subject to a condition preventing me from doing work relating to the carrying on of a licensable activity) and that my licence will become invalid if I cease to be entitled to live and work in
--------------------	---

	<p>the UK (please read guidance note 15).</p> <ul style="list-style-type: none"> The DPS named in this application form is entitled to work in the UK (and is not subject to conditions preventing him or her from doing work relating to a licensable activity) and I have seen a copy of his or her proof of entitlement to work, or have conducted an online right to work check using the Home Office online right to work checking service which confirmed their right to work (please see note 15)
Signature	
Date	01/07/2025
Capacity	APPLICANT / OWNER

For joint applications, signature of 2nd applicant or 2nd applicant's solicitor or other authorised agent (please read guidance note 13). If signing on behalf of the applicant, please state in what capacity.

Signature	
Date	
Capacity	

Contact name (where not previously given) and postal address for correspondence associated with this application (please read guidance note 14)			
Post town		Postcode	
Telephone number (if any)			
If you would prefer us to correspond with you by e-mail, your e-mail address (optional)			

Notes for Guidance

AMIGO GRILL 27 NARBOROUGH ROAD LEICESTER

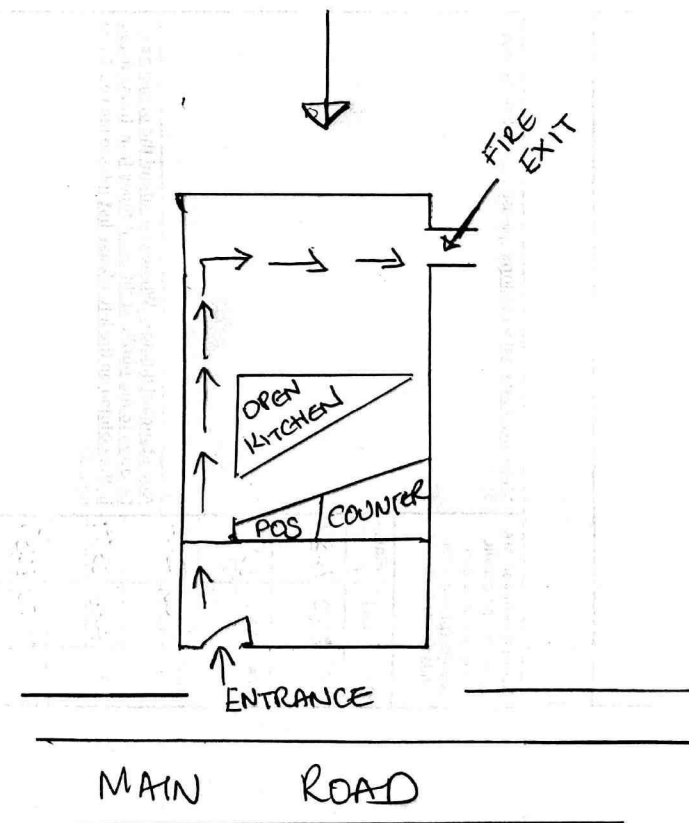



**Leicestershire
Police**
Protecting our communities

Force Licensing Department
Mansfield House
74 Belgrave Gate
Leicester LE1 3GG
Tel: 101
www.leics.police.uk

Leicestershire Police

Licensing Act 2003 – Representation in respect of a New Premises Licence Application.

Details of person or body making representation	
Your Name:	PC Jefferson Pritchard
Your Address:	Force Licensing Department, Mansfield House Police Station, 74 Belgrave Gate, Leicester. LE1 3GG

Details of premises representation is about	
Name of Premises:	Amigo Grill / Red Velvet Desserts.
Address of premises:	27 Narborough Road Leicester LE3 0LE
Application No. (if known)	

Please tick one or more of the licensing objectives that your representation relates to:	
Prevention of crime and disorder	<input checked="" type="checkbox"/>
Public Safety	<input type="checkbox"/>
Prevention of public nuisance	<input checked="" type="checkbox"/>
Protection of children from harm	<input checked="" type="checkbox"/>

Please summarise your concerns about this application:
<p>I write in my capacity as Leicester City centre's alcohol licensing officer for Leicestershire Police, with delegated authority from the Chief Constable.</p> <p>My representation to this new premises licence application is based upon three of the four licensing objectives as per the Licensing Act 2003. Those being:</p> <p>(1) The prevention of crime and disorder.</p> <p>(2) The prevention of public nuisance.</p>

(3) The protection of children from harm.

This is a new application for 27 Narborough Road, Leicester. LE3 0LE.

The two previous applications were rejected as the applicant failed to correctly advertise the proposal in the local press.

The application describes the premises as being a hot and cold desert shop, which also supplies pizza and other hot food.

Therefore, the only requested licensable activity is the provision of late-night refreshment, daily from 11pm until 5am.

The applicant states the premises will be open to the public daily from 9:30am until 5am.

The premises is located on the city bound carriage way of Narborough Road, opposite Celt Street.

Narborough Road acts as a major arterial route into and out of the city and is busy 24 hours a day from both a pedestrian and motor vehicle perspective.

The Narborough Road corridor is a high-density residential area, with a lot of licensed premises and other similar premises located on the ground floor, with residential properties above. The surrounding streets consist of terraced housing.

The premises itself backs onto residential properties along Cranmer Street.

The premises is located within an area of "special interest" as referred to in Leicester City Council's Statement of Licensing Policy 2022-2027.

The application does not refer to this policy, so it is unclear if the applicant is aware and/or has considered the significance of the area, when submitting the application.

The application itself is vague and lacks any mitigating measures in order to promote the licensing objectives.

The applicant does refer to "*CCTV and trained staff members*" within Section M but does not elaborate.

The proposed operating hours until 5am in the morning, gives Leicestershire Police concern and more so given existing challenges that other late-night operators already face.

Leicestershire Police believe the premises will act as a magnet and will result in people congregating inside and outside the venue in the early hours of morning, as they source hot and/or cold food and are likely to be under the influence of alcohol.

Several licensed premises which supply alcohol are located nearby at 11, 13, 17 and 29 Narborough Road.

Therefore, there is a real possibility of anti-social behaviour in the form of noise and even crime and disorder, as customers congregate.

It is also possible that two nearby 24/7 gaming centres at 35-37 and 39-41 Narborough Road will draw customers to the venue in the early hours of the morning.

Given the nature of the business, there is a strong possibility that younger clientele and children under the age of 18 years will attend the premises in the night-time economy/early hours of the morning. The application does not address how the applicant would protect these children from harm at this time of the morning.

Leicestershire Police respectfully requests the application is refused as it fails to promote the licensing objectives.

PC2093 Jefferson Pritchard

Leicestershire Police – Alcohol Licensing for Leicester City Centre

Representation dated – Tuesday 18th November 2025.

Licensing Act 2003 - Representation in respect of an application for a ~~minor variation~~ new premises



Details of person or body making representation	
Your Name:	Jasvinder Mann
Your Address:	Noise and Pollution Team City Hall 115 Charles Street Leicester LE1 1FZ

Details of premises representation is about	
Name of Premises:	Amigo Grill
Address of premises:	37 Narborough Road Leicester
Application No. (if known)	

Please tick one or more of the licensing objectives that your representation relates to:	
Prevention of crime and disorder	No
Public Safety	No
Prevention of public nuisance	Yes
Protection of children from harm	No

Please summarise your concerns about this application:
<p>Narborough Road is a busy street with many similar hot takeaway premises in the vicinity. There are residential properties directly behind with a flat on the first floor.</p> <p>The main concerns with this application are regarding the opening times and the provision of late-night refreshment which have been requested until 05:00 AM on all days. Although Narborough Road is a busy business area, it does quieten down into the early hours of the morning. The main sources of noise would be the operation of the ventilation flue, people noise and delivery vehicles, potentially impacting the properties behind as well as the flat above. Also, there is potential for delivery vehicles coming and going to disrupt the flat above.</p> <p>I have consulted the licensing database and this shows that the premises previously operated until 04:00 on all days including late night refreshment. There were no known issues with the premises in terms of noise/odour.</p>

I object to the licence as it stands due to the above however after talking to the applicant, he is willing to agree to operate until 04:00 and attach the below conditions:

- No waste or recyclable materials, including bottles, shall be moved removed from or placed in outside areas between 23:00 and 07:30.
- The licence holder must ensure all noise from delivery drivers and vehicles is kept to a minimum when approaching and leaving the premise.

Haleema Khan
Amigo Grill
27 Narborough Road
Leicester
LE3 0LE

Licensing Act 2003 – New Premises Licence.
Prevention of Public Nuisance.
Amigo Grill, 37 Narborough Road, Leicester

I, _____ (full name) as the applicant / applicant's
representative of the above premises licence, hereby agree to the following
modifications in respect to prevention of public nuisance.

Hours Open to the Public:

Requested: Monday – Sunday: 23:00 – 05:00

Agreed: Monday – Sunday: 23:00 – 04:00

Late Night Refreshment:

Requested: Monday – Sunday: 23:00 – 05:00

Agreed: Monday – Sunday: 23:00 – 04:00

Additional conditions:

- No waste or recyclable materials, including bottles, shall be moved removed from or placed in outside areas between 23:00 and 07:30.
- The licence holder must ensure all noise from delivery drivers and vehicles is kept to a minimum when approaching and leaving the premise.

Signed H.Khan.....

Name: Haleema Khan
(PRINT)
10/12/2025
Dated:.....

CONDITIONS

CONDITIONS CONSISTENT WITH THE OPERATING SCHEDULE
The licence holder will ensure CCTV is in place at the premises and staff members are trained to use this.
CONDITIONS CONSISTENT WITH THE REPRESENTATION AND AGREEMENT FROM THE NOISE AND POLLUTION CONTROL TEAM
<p>The opening hours of the premises to be: Monday to Sunday 09.30 – 04.00</p> <p>Late night refreshment: Monday to Sunday – 23.00 – 04.00</p>
No waste or recyclable materials, including bottles, shall be moved removed from or placed in outside areas between 23:00 and 07:30.
The licence holder must ensure all noise from delivery drivers and vehicles is kept to a minimum when approaching and leaving the premises.

